

The square footages and room size information are deemed to be reliable but are not guaranteed and should be independently verified. This drawing is for marketing purposes only.

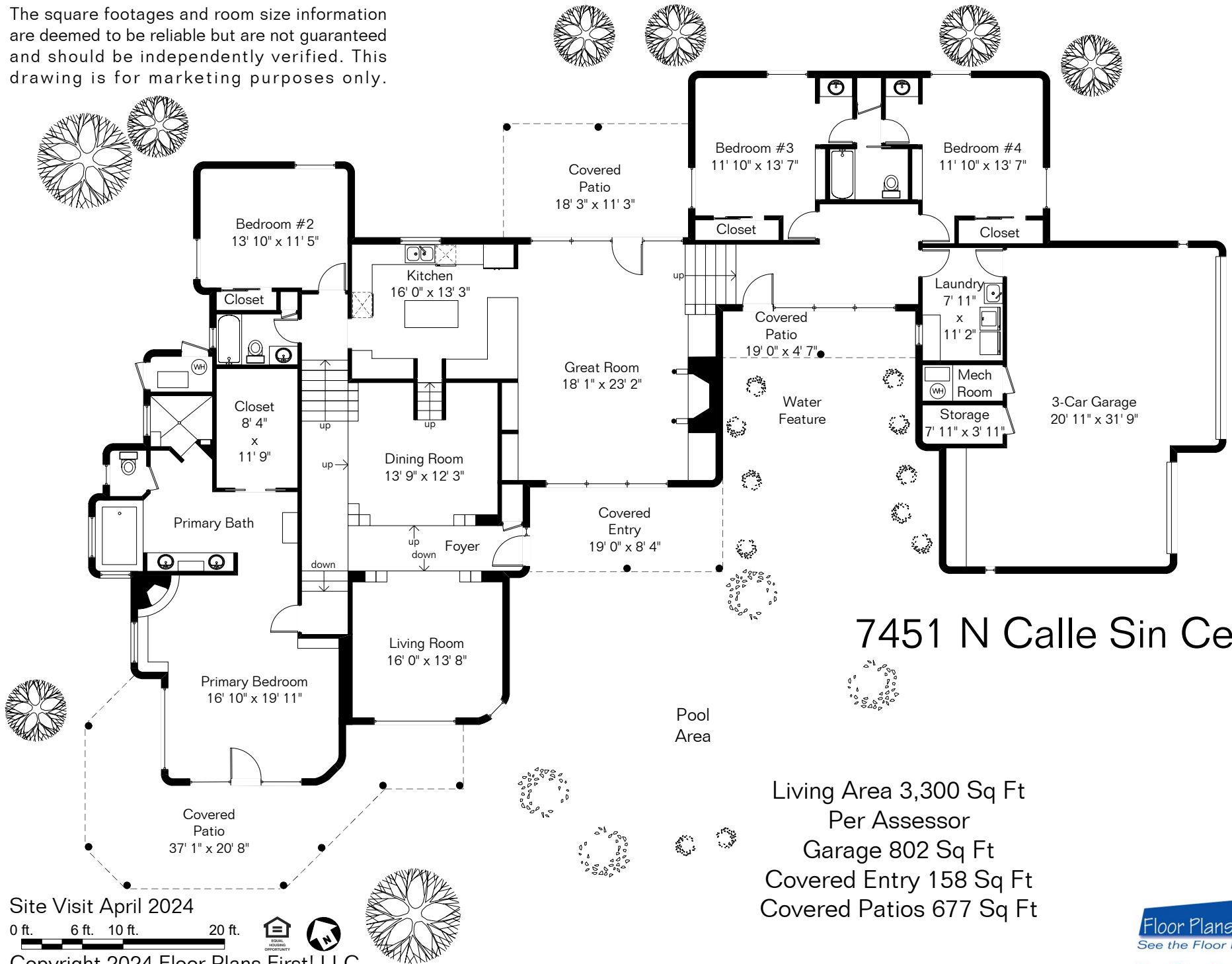

7451 N Calle Sin Celo

Living Area 3,300 Sq Ft
 Per Assessor
 Garage 802 Sq Ft
 Covered Entry 158 Sq Ft
 Covered Patios 677 Sq Ft

Site Visit April 2024
 0 ft. 6 ft. 10 ft. 20 ft.
 Copyright 2024 Floor Plans First! LLC
 All Rights Reserved.

Floor Plans First!
 See the Floor Plan First!
 FloorPlansFirst.com
 (520) 881-1500